

**City of Globe**  
150 N. Pine Street  
Globe, AZ 85501

**ADDENDUM #1**  
**TO THE JUNE 25, 2025**  
**INVITATION TO BID**  
**FOR THE**  
**GLOBE SKATE PARK IMPROVEMENTS PROJECT**

**Addendum #1 Date: 07/14/2025**

This addendum, and all the information contained herein and attached hereto, shall become as fully a part of the INVITATION TO SUBMIT BIDS and other BID/CONTRACT DOCUMENTS for the **CITY OF GLOBE SKATE PARK IMPROVEMENTS PROJECT**, as if therein included, and shall take full and complete preference over anything therein contained to the contrary.

**Acknowledgement: Each Bidder shall acknowledge receipt of this Addendum in their bid package on the Bid Form.**

Each bidder, firm, contractor, subcontractor, or supplier shall be responsible for reading each and every item in this addendum to ascertain to what extent and in what manner it affects the work that they are interested in.

---

**RESPONSES RECEIVED TO QUESTIONS FROM PROSPECTIVE BIDDERS**

1. Question: Are there specifications for the skate park equipment – manufacturer, part number, or type number?

Answer: The city will only provide dimensions of a general proposed layout. Other designs are up for consideration.

2. Question: Is there a design?

Answer: The city has provided a general proposed layout, attached to this addendum, but other designs are up for consideration.

3. Question: Is the proposal based on a 'best value bid method'?

Answer: Contractors are expected to submit a proposal that provides the best value for the City.

4. Question: Is there a project estimate?

Answer: Approximately \$150,000 to \$250,000.

5. Question: Are the sidewalk and picnic pads the priority?

Answer: Yes. The city can lose a few ramps or pieces of equipment, but the sidewalks and picnic pads are the priority.

6. Question: What about the handrail location? If it's put where the drawing indicates, kids will use it as part of the skate park. Can it be moved?

Answer: Bid per plan.

---

Attachments:

- 07-14-2025 Proposed Skate Park General Layout

\*\*\* End of Addendum #1 \*\*\*

07-14-2025 Proposed Skate Park General Layout

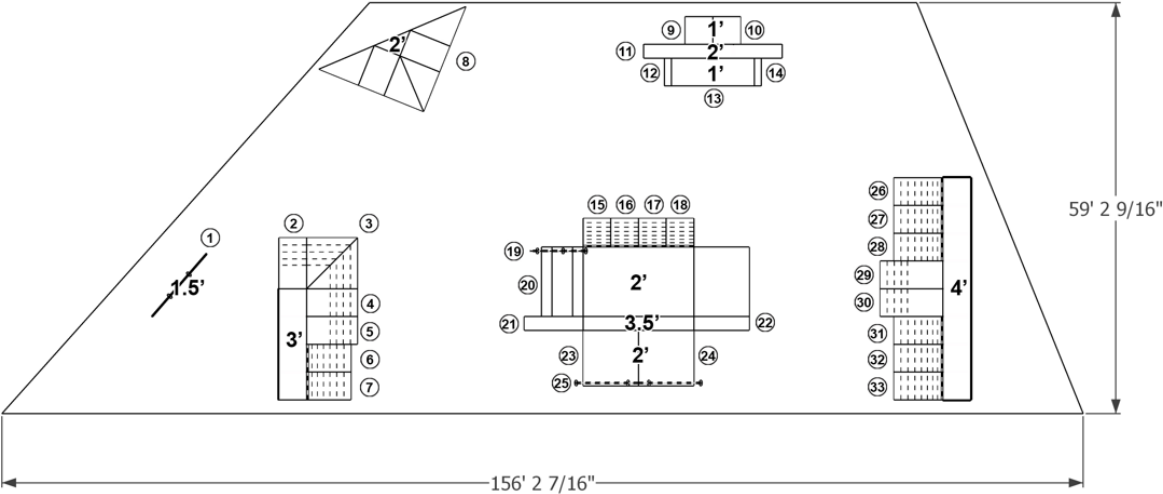
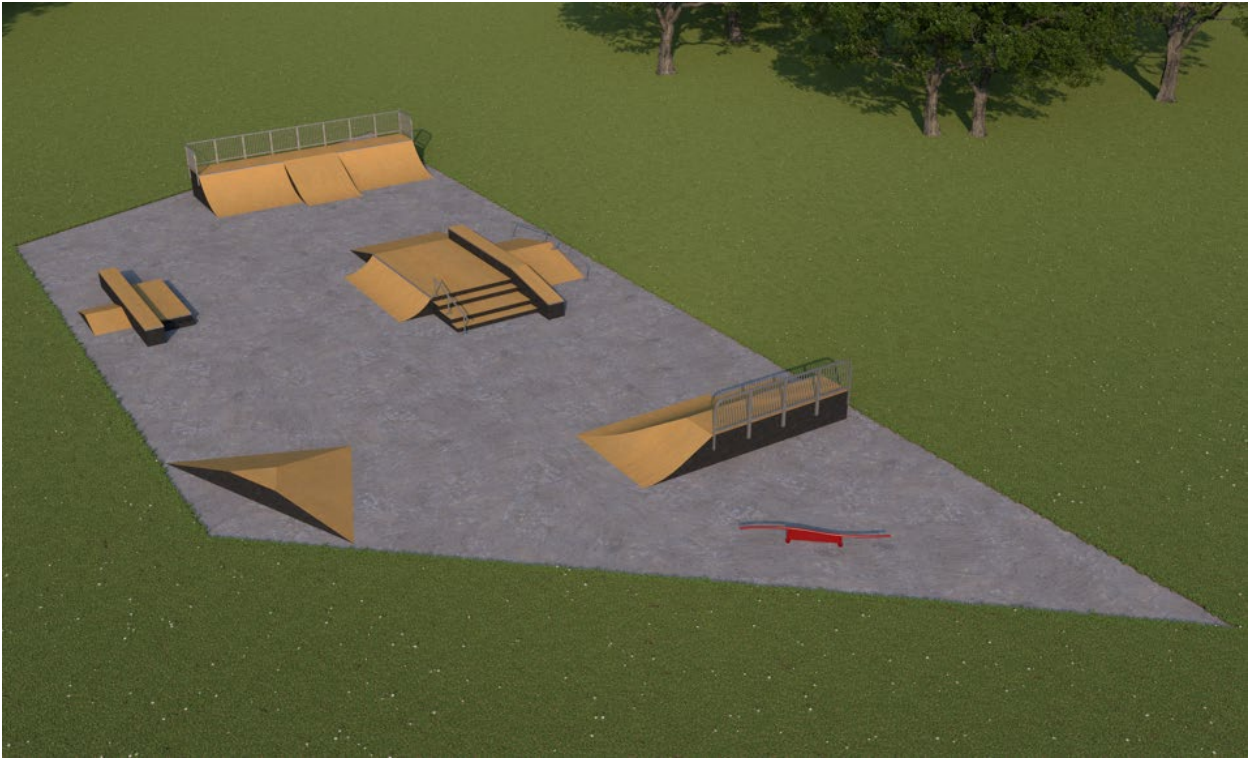

## 07-14-2025 Proposed Skate Park General Layout

<u>Item</u>	<u>Obstacle</u>	<u>Height</u>	<u>Width</u>	<u>Length</u>	<u>Pro Series</u>
1	Rail	1.5	0.2'	12.0'	
2	Bank Ramp	3	4.0'	7.0'	
3	Pyramid Corner (Bank Ramp) 90 Degree	3	7.3'	7.3'	
4	Bank Ramp	3.0'	4.0'	11.0'	
5	Bank Ramp	3.0'	4.0'	11.0'	
6	Quarter Pipe	3.0'	4.0'	10.0'	
7	Quarter Pipe	3.0'	4.0'	10.0'	
8	Pyramid Section (Wedge)	2.0'	6.0'	20.0'	
9	Bank Ramp (Wedge)	1	4.0'	4.0'	
10	Bank Ramp (Wedge)	1	4.0'	4.0'	
11	Grindbox (2' Wide)	2	2.0'	20.0'	
12	Stairs	1	4.0'	1.0'	
13	Grindbox	1	4.0'	12.0'	
14	Stairs	1	4.0'	1.0'	
15	Quarter Pipe	2	4.0'	5.0'	
16	Quarter Pipe	2	4.0'	5.0'	
17	Quarter Pipe	2	4.0'	5.0'	
18	Quarter Pipe	2	4.0'	5.0'	
19	Grind Rail (Round)	2.0'	2"	8.0'	
20	Wedge, Flat, Stair	2.0'	10.0'	30.0'	
21	Planter (2' wide)	3.5	2.0'	24.5'	
22	Bank Ramp (Wedge) 2' Wide	2	2.0'	8.0'	
23	Bank Ramp (Wedge)	2.0'	8.0'	8.0'	
24	Bank Ramp (Wedge)	2.0'	8.0'	8.0'	
25	Grind Rail, Kinked (Round)	1.5'	2"	18.0'	
26	Quarter Pipe	4	4.0'	11.0'	
27	Quarter Pipe	4	4.0'	11.0'	
28	Quarter Pipe	4	4.0'	11.0'	
29	Bank Ramp	4	4.0'	13.0'	
30	Bank Ramp	4	4.0'	13.0'	
31	Quarter Pipe	4	4.0'	11.0'	
32	Quarter Pipe	4	4.0'	11.0'	
33	Quarter Pipe	4	4.0'	11.0'	